



**Reconstruction/Rehabilitation of Tkibuli Public School  
(Tkibuli Municipality)**

**Environmental and Social Screening Report and  
Environmental and Social Management Plan**

**WORLD BANK FINANCED  
INNOVATION, INCLUSION AND QUALITY PROJECT (GEORGIA I2Q PROJECT)**

**Tbilisi, Georgia**

**May 2023**

## Sub-project Description

Rehabilitation of the village Tkibuli Public School in Tkibuli Municipality is one of the sub-projects (SP) implemented under the Innovation, Inclusion and Quality Project (Georgia I2Q Project).

The SP area is located in the Tkibuli Municipality (land plot is under state ownership cadastral code 39.01.26.674) and its territory is 10 926 m<sup>2</sup>. The land plot is under the State ownership. SP site can be accessed through the Tabukashvili and Vaja Pshavela street, distance from Tbilisi is about 232 km. The nearest residential building to the school is approximately 15-20 m away.

In accordance with the revised scheme of seismic regions of the territory of Georgia, the SP site falls in the 8-point seismic activity zone according to the MSK64 scale (Order of the Minister of Economic Development of Georgia No. 1-1/2284, October 7, 2009). Study of the structural integrity of the school building was carried out in November 2021. Recommendations on the need for building reinforcement informed development of the school rehabilitation design. In May 2023, the design passed expert examination by the accredited governmental office Levan Samkharauli National Forensics Bureau.

Tkibuli School consists of one main and another auxiliary building of comparatively small size, in both buildings the teaching process is taking place. At present, 480 students are attending the school in one shift; among them there are 9 pupils with special educational needs, the school serves about 350-400 local households, whose children study there. During construction works, all students (includes vulnerable/minority groups) will have the proper access to the studding process. In case renovation activities have to be undertaken in parallel with the teaching process, the staff of the school and the children will be temporarily moved to Tkibuli N3 public school, distance from the SP is about 2 km. The Ministry of Education and Science (MES) will ensure all temporary arrangements for teaching and transportation of students to the selected location, 25-30 minibus will be allocated during school rehabilitation period. The SP doesn't involve land acquisition or physical relocation. Nor will students' transportation to be organized by the MES for the period of rehabilitation works result in economic displacement (e.g., for formal or informal vendors).

Electricity is supplied to the facility without interruption. The school is connected to the public potable water network. As for the disposal of local wastewater, local population uses simple earth or concrete pits, which serve as septic. These facilities are located underground and do not cause insanitariness and environmental pollution.

The SP foresees the implementation of the following works:

- Preparatory works (fencing of the construction site, installation of temporary structures such as WCs, changing rooms for the workers, guard booth, storages for materials as well as household and hazardous waste disposal sites);
- Rehabilitation of the external engineering networks and installation of the new ones;
- Installation of fire alarm and firefighting systems;
- Adaptation of the building for the persons with disabilities;
- Installation of water supply, heating and electrical networks for the building. Connection of the building to the existing municipal potable water supply network.
- Installation of a biological treatment unit for receiving sewage.
- Upgrade of the territory around the school building.

The existing school building is not adapted for people with disabilities or other special needs.

There are several trees and bushes in the school yard. According to the design of rehabilitation works, there is no need to cut the existing plants. Removal of topsoil is not considered either, however, if it is necessary to remove it in any section, it will be temporarily stored on the construction site in accordance with the requirements stipulated of the technical regulations approved by the Resolution N424 of the Government of Georgia of December 31, 2013, on the Removal, Storage, Use, and Reclamation of Topsoil.

## Environmental and Social Screening and Classification of Subprojects

### (A) IMPACT IDENTIFICATION

<p>Does the sub-project have tangible impact on the environment?</p>	<p>The SP will have a modest negative environmental impact.</p> <p>The main impact will be related to the construction phase, which includes works for rehabilitation of the school building, demolition of the existing boiler building and construction of the new one, rehabilitation of the external engineering networks and installation of the new ones, landscaping of the school territory.</p>
<p>What are the significant beneficial and adverse environmental effects of sub-project?</p>	<p>The expected negative environmental impact will be short-term and typical for small-scale construction works in modified landscape: noise, dust, vibration, and emissions from the operation of construction machinery; generation of construction waste. The later impacts are related to the generation of waste from maintenance of the school which will be managed by the local municipality.</p> <p>The SP is located in the area with modified environment. The impact will be transitory and insignificant (noise, emissions, construction waste, temporary disturbance of traffic and access, etc.).</p> <p>In operation phase, proper management of generated solid waste should be ensured to reduce impact on the environment.</p>
<p>May the sub-project have any significant impact on the local communities and other affected people?</p>	<p>The SP is expected to have a long-term positive social impact, as the local residents will be able to have access to the modern school, which will be also adapted to the people with disabilities.</p> <p>Ultimate goal of the SP is to improve the quality and conditions of education for children in Tkhibili town. Reconstruction of the school will bring immediate benefits to its users through improved learning spaces, playgrounds, everyday learning activities and in general infrastructure and living conditions. The long-term social impact will be beneficial, as local children and teachers in school will be provided with improved educational and working conditions, increased income of population during the implementation (employment of workers), and after the construction.</p> <p>The SP will create temporary and some permanent job opportunities for the local population (both men and women), as they could be employed during rehabilitation and maintenance. Availability of modern school in the community will allow more people (especially those having school age children) to stay in the Tkhibili Municipality.</p> <p>Negative impact is short term and limited to the construction site. It is related to the possible disturbance described above.</p> <p>In case renovation activities have to be undertaken in parallel with the teaching process, an option of temporary moving the teaching process to Tkhibili N3 public school.</p> <p>The SP envisages adaption of the school building for persons with disabilities.</p> <p>The SP doesn't envisage land take or resettlement, as well as economic displacement (for example, for formal or informal vendors).</p>

**(B) MITIGATION MEASURES**

<p>Were there any alternatives to the sub-project design considered?</p>	<p>As the SP envisages rehabilitation of the existing school building, alternatives regarding the SP design were not considered.</p>
<p>What types of mitigation measures are proposed?</p>	<p>The expected negative impacts of the construction phase can be easily mitigated through proper management of construction activities. The contractor will be responsible for the waste disposal at the permitted location, use the quarry materials from the licensed quarries only or obtain materials only from licensed providers, prevent water and soil from pollution (fuel spills due to equipment failure, concrete spills etc.), avoid disturbance of population (noise, dust, emissions) through proper work/supplies scheduling, traffic management, and good maintenance of the construction machinery.</p> <p>Revision of vehicles will be required to ensure that there is no leakage of fuel and lubricating materials, all machinery will be maintained and operated such that all leaks and spills of materials will be minimized, the contractor will be required to organize and cover material storage areas. The material storage sites will be protected from washing out during heavy rainfalls and flooding through covering by impermeable materials; car maintenance points will not be located within 50 m of any watercourse.</p> <p>During SP implementation, warning signs will be used, and traffic will be managed around the work sites.</p> <p>Community health and safety will be an issue during the construction phase as residential buildings are located near the project site. The contractor will be responsible for taking specific measures to mitigate the impact on locals, including informing the affected population on the upcoming works and any temporary disruptions of municipal services, limiting working hours to daytime, limiting the speed of moving construction vehicles &amp; machinery, minimizing noise &amp; dust emissions, etc.</p> <p>In case renovation activities have to be undertaken in parallel with the teaching process, the staff of the school and the children will be temporarily moved to Tkibuli N3 public school. The Ministry of Education and Science (MES) will ensure all temporary arrangements for teaching and transportation of students to the selected location.</p> <p>No major hazards are expected during the renovation works, as long as proper construction practices and safety procedures are applied. School rehabilitation activities will be undertaken preferably during summer months (non-operation period for school) to minimize hindering the teaching process and to eliminate the risk of accidents involving children.</p> <p>Due to construction work removal of topsoil is not considered, however if it is necessary to remove it in any section, it will be temporarily stored on the construction site in accordance with the requirements stipulated of the technical regulations approved by the Resolution N424 of the Government of Georgia of</p>

	December 31, 2013, on the Removal, Storage, Use, and Reclamation of Topsoil.
What lessons from the previous similar projects have been incorporated into the sub-project design?	<p>MDF has a vast experience in the implementation of reconstruction / rehabilitation for medium and large-scale buildings (including public schools and kindergartens) roads and streets financed by various donor organizations. Based on lessons learned from previous similar projects, design envisages not only the rehabilitation of the school, but also the improvement of heating, ventilation and fire control system, hot water supply, lighting systems and reference energy saving potential, implementation of energy efficiency improvement measures.</p> <p>The infrastructure of the school will be adapted for receiving and servicing of people with disabilities.</p>
Have concerned communities been involved and have their interests and knowledge been adequately taken into consideration in sub-project preparation?	<p>The SP has been developed by the MES, together with local resource center, as a response to the current situation.</p> <p>ESMP drafted for the SP will be made available for the beneficiaries and other interested parties and will be discussed in a consultation meeting.</p> <p>Information about the public consultation meeting will be announced both on the official websites of the MDF and MES, as well as on the information boards of the school and the local municipality building.</p> <p>The public discussion will be organized by MDF and MES. The public discussion will be attended by all the interested parties, including parents of the school students. Information about the exact time and place of the public consultation meeting will be announced at least 10 days before.</p> <p>In case a lockdown is introduced due to COVID or other infectious disease breakdown, conducting of a virtual consultation may be required and the details of that will be worked out in a due time.</p>

(C) CATEGORIZATION AND CONCLUSION

1. Subproject is declined
2. Subproject is accepted

Subproject preparation requires:

1. Completion of the Environmental and Social Management Checklist for Small Construction and Rehabilitation Activities
2. Environmental and Social Review, including development of Environmental and Social Management Plan

### Social and Cultural Resource Screening of SP

Social safeguards screening information		Yes	No
1	Is the information related to the affiliation, ownership, and land use status of the sub-project site available and verifiable? (The screening cannot be completed until this is available)	X	
2	Will the sub-project reduce people's access to their economic resources, such as land, pasture, water, public services, sites of common public use or other resources that they depend on?		X
3	Will the sub-project result in resettlement of individuals or families or require the acquisition of land (public or private, temporarily or permanently) for its development?		X
4	Will the project result in the temporary or permanent loss of crops, fruit trees and household infra-structure (such as ancillary facilities, fence, canal, granaries, outside toilets and kitchens, etc.)?		X
If answer to any above question (except question 1) is "Yes", then <b>OP/BP 4.12 Involuntary Resettlement</b> is applicable and mitigation measures should follow this OP/BP 4.12 and the resettlement Policy Framework			
Cultural resources safeguard screening information		Yes	No
5	Will the project require excavation near any historical, archaeological or cultural heritage site?		X
If answer to question 5 is "Yes", then <b>OP/BP 4.11 Physical Cultural Resources</b> is applicable and possible chance finds must be handled in accordance with OP/BP and relevant procedures provided in the Environmental and Social Management Framework.			

## Environmental and Social Management Plan

### PART A: GENERAL PROJECT AND SITE INFORMATION

INSTITUTIONAL & ADMINISTRATIVE	
Country	Georgia
Project title	INNOVATION, INCLUSION AND QUALITY PROJECT (GEORGIA I2Q PROJECT)
Sub-Project title	Reconstruction/Rehabilitation of Tkibuli Public School
Scope of site-specific activity	<p>Rehabilitation of the village Tkibuli Public School in Tkibuli Municipality is one of the sub-projects (SP) implemented under the Innovation, Inclusion and Quality Project (Georgia I2Q Project).</p> <p>The SP area is located in the Tkibuli Municipality (land plot is under state ownership cadastral code 39.01.26.674) and its territory is 10 926 m<sup>2</sup>. The land plot is under the State ownership. SP site can be accessed through the Tabukashvili and Vaja Pshavela street, distance from Tbilisi is about 232 km. The nearest residential building to the school is approximately 15-20 m away.</p> <p>In accordance with the revised scheme of seismic regions of the territory of Georgia, the SP site falls in the 8-point seismic activity zone according to the MSK64 scale (Order of the Minister of Economic Development of Georgia No. 1-1/2284, October 7, 2009). Study of the structural integrity of the school building was carried out in November 2021. Recommendations on the need for building reinforcement informed development of the school rehabilitation design. In May 2023, the design passed expert examination by the accredited governmental office Levan Samkharauli National Forensics Bureau.</p> <p>Tkibuli School consists of one main and another auxiliary building of comparatively small size, in both buildings the teaching process is taking place. At present, 480 students are attending the school in one shift; among them there are 9 pupils with special educational needs, the school serves about 350-400 local households, whose children study there. During construction works, all students (includes vulnerable/minority groups) will have the proper access to the studding process. In case renovation activities have to be undertaken in parallel with the teaching process, the staff of the school and the children will be temporarily moved to Tkibuli N3 public school, distance from the SP is about 2 km. The Ministry of Education and Science (MES) will ensure all temporary arrangements for teaching and transportation of students to the selected location, 25-30 minibus will be allocated during school rehabilitation period. The SP doesn't involve land acquisition or physical relocation. Nor will students' transportation to be organized by the MES for the period of rehabilitation works result in economic displacement (e.g., for formal or informal vendors).</p>

Institutional arrangements (WB)	Task Team Leader Shiro Nakata	Safeguards Specialists: Darejan Kapanadze – <i>Environment</i> Davit Jijelava – <i>Social</i>	
Implementation arrangements (Borrower)	Implementing entity: Municipal Development Fund of Georgia	Works supervisor: Company Eptisa Servicios de Ingenieria S.L. Spain	Works contractor: TBD
<b>SITE DESCRIPTION</b>			
Name of institution whose premises are to be rehabilitated	Tkibuli Public school		
Address and site location of institution whose premises are to be rehabilitated	Tkhibili city Tel: 577531714 Email: tkibuli1@mes.gov.ge		
Who owns the land? Who uses the land (formal/informal)?	The land plot is under the State ownership		
Description of physical and natural environment, and of the socio-economic context around the site	<p>Tkibuli Region, which means ancient Okriba, is nearly 600-800 meters above sea level in western Georgia, Imereti. The town is built on both banks of the river Tkibula (which is a right tributary of the Kvirila) and is surrounded with hilly forests.</p> <p>Ambrolauri municipality borders Tkibuli on the North, Chiatura --on the South-East, Kutaisi is on the South –West and Tskaltubo borders the region on the West. The length of boundaries is 120 km long and the whole area covers 470 square kilometres.</p> <p>The following rivers flow through the territory: The Lekhidari, The Dzusa, The Tkibula, The Magara-Chishura, The Tskaltsitela, The Qvekhura. There are several waterfalls in Mukhura and Dzmuisi.</p> <p>Flora and Fauna are represented by Kholhki and Caucasian endemic species and breeds. Some of the relict plants are box trees, pontic rhododendron, chestnut trees and utkhovari. Village Sotchkheti still keeps a 1500- year- old tree. Tsutskhvati community has planted forests of Uthkovari trees, Chestnut woods are also illustrated as a mountain gorge on the banks of rivers Tkibula and Dzusa.</p> <p>Tkibuli is rich in minerals such as coal, schist, chalcedony, teshenite ,quartz sands, barytes, marble, basalt, jet, fire -proof clay good for cement production as well. Kursebi, Bueti, Sotchkheti Koka, Tsutskhvati, Mukhura, and Legva are the list of villages where Mineral waters run through.</p> <p>In Municipality of Tkibuli there are 10 territorial units: Town of Tkibuli; 7 communities: Gurna, Kursebi , Orpiri, Satsire , Sotchkheti, Khresili, Djvarisa; and 2 villages: Mukhura and Tsutskhvati. There are 45 villages in total. Georgians are 99%</p>		



	<p>of population, Russians and Ukrainians also live in the region. The population of the town is 14000 people, while the village inhabitants are 17000.</p> <p>The main product of agriculture is maize. Viticulture is well developed as well as tea production. Some of important fields of agriculture are stockbreeding, beekeeping and fruit-growing. The main industry of Tkibuli remains coal mining. The first deposit of this stone was discovered in 1825 and since 1846 it has been processing and exploiting. The term of “Okriba” first was mentioned in compilations of Nikortsminda Church dated back to 1071. The town name “Tkibuli “is dated to 1259-1293 in the historical source written by Gelati Church deacon Jacob as a sacrifice for Mother of God.</p> <p>Okriba is famous for its historical monuments. They attract visitors by their mosaic, paintings, fresco, and lapidary inscriptions.</p> <p>Among maintained historical monuments The Gelati – the Monasterial Complex - is the most important one. It is included in UNESCO’s World Heritage Site list together with the Bagrati Cathedral. Besides those two monuments on the territory of Okriba, there are the Motsameta monastery and Nakalakari. Tsutskhvati, djvarisa and Satsire castles are also represented as monuments of old times.</p> <p>One of the wonders of nature in Tkibuli region is the cave in Tsutskhvati, which consists of 13 floors, on several floors stalagmites and stalactites are represented. Among caves, “warm caves“ are in majority. They were used by primeval societies. This unique cave used to be the place for cultish events that has no analogue throughout the history. Some archeological monuments are found in the cave from the Paleolithic period to the Bronze Age and The Historic Era. Approximately 40 different animal bones have been discovered in this cave too.</p> <p>In Tkibuli, apart from Gelati and Motsameta monasterial complexes, Tsutskhvati Cave (which has been announced as a natural preserve since 1974) can easily become one of the most important tourist attractions together with Tskhrajvari. Tkibuli and Shaori water reservoirs can serve tourists as a recreation places.</p>
<p>Locations and distance for material sourcing, especially aggregates, water, stones?</p>	<p>The nearest legal landfill for non-hazardous waste near the SP area is approximately 7-10 km away located in Tkhbuli Municipality, Manchieti village.</p> <p>Distance to the nearest licensed borrow pit on the river Rioni, in Ambrolauri Municipality is approximately 40 km away from the SP</p>
<b>LEGISLATION</b>	
<p>National &amp; local legislation &amp; permits that apply to project activity</p>	<p>The Project is implemented in compliance with OP/BP 4.01 - Environmental Assessment, the safeguard policy of the World Bank. Based on this Policy, the present school rehabilitation is classed as environmental category "B", and the present ESMP has been prepared for rehabilitation works in accordance with the principles of OP/BP 4.01 and the Environmental and Social Management Framework (ESMF).</p> <p>According to Georgian law, school rehabilitation does not need an environmental effect assessment and Environmental Decision. With the national regulation system, however:</p>

	<ul style="list-style-type: none"> <li>(i) construction materials must be obtained from licensed suppliers</li> <li>(ii) if the contractor wishes to open a quarry, he must obtain a license from the National Agency for Mineral Resources, which falls under the Ministry of Economy and Sustainable Development.</li> <li>(iii) Assume that the contractor's operations create over 200 tons of non-hazardous waste, over 1,000 tons of inert materials, or over 120 kg of hazardous waste yearly. In such a case, the contractor must prepare and obtain Ministry of Environmental Protection and Agriculture (MoEPA) approval on the Waste Management Plan, prepare the report on waste inventory, and appoint an environmental manager whose identity information must be submitted to MoEPA in accordance with the Waste Management Code.</li> <li>(iv) Construction waste must be disposed of in the official landfill in accordance with the agreement with the Solid Waste Management Company or at the pre-selected location that has been formally agreed upon with the local government.</li> <li>(v) The topsoil shall be excavated and stored in accordance with the regulations outlined in Resolution N424 of the Government of Georgia dated December 31, 2013, on the Excavation, Storage, Usage, and Reclamation of Landfill Materials of Topsoil.</li> </ul>
--	---

**GRIEVANCE REDRESS MECHANISM**

A grievance redress mechanism (GRM) will be available to allow project-affected people (PAP) appealing any action or decision on which they disagree.

PAPs will be informed about the available GRM during public consultations and through distributing of brochures prior to commencement of works. In addition, an announcement with relevant information will be displayed on the information boards in the lobbies of buildings of local municipality. APs will be fully informed of their rights and of the procedures for addressing complaints either verbally or in writing during pre-contracting, construction, and operation periods. Care will always be taken to prevent grievances rather than going through a redress process.

Received grievances will be lodged to the Ministry of Education and Science of Georgia (MES) and to the MDF. As for grievance monitoring MES and MDF registers, all received compliances, comments, and how the compliance will be addressed. During public consultations, the local population will be informed about the grievance redress process and received information about contact persons.

The contact person from the MES is Marine Zhvania (Tel: +995 577 27 88 41, [marina.zhvania@iiq.gov.ge](mailto:marina.zhvania@iiq.gov.ge), 0102 Tbilisi, Dimitri Uznadze N 52);

The contact person from the MDF is David Arsenashvili (Tel: +599 019 183, [feedback@mdf.org.ge](mailto:feedback@mdf.org.ge), 150 Davit Aghmashenebeli ave., 4th floor, 0112 Tbilisi, Georgia)

**PUBLIC CONSULTATION**

Identify when / where the public consultation process will take place	<p>Information about the public consultation meeting will be announced both on the official websites of the MDF and MES, as well as on the information boards of the school and local municipality building.</p> <p>The public discussion will be organized by MDF and MES. The public discussion will be attended by all interested parties, including parents of the school students. Information about the exact time and place of the public consultation meeting will</p>
---	--

	<p>be announced at least 10 days in advance.</p> <p>In case a lockdown is introduced due to COVID or other infectious disease breakdown, conducting of a virtual consultation may be required and the details of that will be worked out in a due time.</p> <p>Records of the public consultation process will be attached to the present ESMP.</p>
<b>ATTACHMENTS</b>	
<p>Attachment 1: Ortho Photo</p> <p>Attachment 2: General Plan</p> <p>Attachment 3: Cadastral Plan</p> <p>Attachment 4: Site photos</p> <p>Attachment 5: Design drawings (3D visualization etc.)</p> <p>Attachment 6: Minutes of public consultation meeting on the draft ESMP (will be provided by MDF)</p> <p>Attachment 7: Permits, licenses, agreement letters (will be provided by contractor)</p>	

**PART B: SAFEGUARDS INFORMATION**

<b>ENVIRONMENTAL /SOCIAL SCREENING</b>			
Will the site activity include/involve any of the following?	<b>Activity/Issue</b>	<b>Status</b>	<b>Triggered Actions</b>
	1. Rehabilitation	<input checked="" type="checkbox"/> Yes <input type="checkbox"/> No	If yes, see Section <b>A</b> below
	2. New construction	<input type="checkbox"/> Yes <input checked="" type="checkbox"/> No	If yes, see Section <b>A</b> below
	3. Individual wastewater treatment system	<input checked="" type="checkbox"/> Yes <input type="checkbox"/> No	If yes, see Section <b>B</b> below
	4. Historic building(s) and districts	<input type="checkbox"/> Yes <input checked="" type="checkbox"/> No	If yes, see Section <b>C</b> below
	5. Acquisition of land <sup>1</sup>	<input type="checkbox"/> Yes <input checked="" type="checkbox"/> No	If yes, see Section <b>D</b> below
	6. Impacts on land and property use	<input type="checkbox"/> Yes <input checked="" type="checkbox"/> No	If yes, see Section <b>E</b> below
	7. Hazardous or toxic materials <sup>2</sup>	<input type="checkbox"/> Yes <input checked="" type="checkbox"/> No	If yes, see Section <b>F</b> below
	8. Impacts on forests and/or protected areas	<input type="checkbox"/> Yes <input checked="" type="checkbox"/> No	If yes, see Section <b>G</b> below
	9. Handling / management of medical waste	<input type="checkbox"/> Yes <input checked="" type="checkbox"/> No	If yes, see Section <b>H</b> below
	10. Traffic and pedestrian safety	<input checked="" type="checkbox"/> Yes <input type="checkbox"/> No	If yes, see Section <b>I</b> below
	11. Community and labor health and safety	<input checked="" type="checkbox"/> Yes <input type="checkbox"/> No	If yes, see Section <b>J</b> below

<sup>1</sup> Land acquisitions includes displacement of people, change of livelihood encroachment on private property this is to land that is purchased/transferred and affects people who are living and/or squatters and/or operate a business (kiosks) on land that is being acquired.

<sup>2</sup> Toxic / hazardous material includes but is not limited to asbestos, lead-containing and other toxic paints, noxious solvents, etc.

**PART C: MITIGATION MEASURES**

ACTIVITY	PARAMETER	MITIGATION MEASURES CHECKLIST
0. General Conditions	Notification and Worker Safety	<ul style="list-style-type: none"> <li>(a) Obtain all legally required permits for construction, extraction, natural construction materials, disposal of waste, and others as relevant.</li> <li>(b) Ensure the supply of personal protective equipment to stall and personnel following good international practice (always hardhats, as needed masks and safety glasses, harnesses, and safety boots), and control its use.</li> <li>(c) Workers’ PPE will comply with international good practice (always hardhats, as needed masks and safety glasses, harnesses and safety boots).</li> <li>(d) Signpost worksites to inform workers of key rules and regulations to follow.</li> <li><b>(e)</b> Put up information on the company undertaking works at each worksite and provide contact information.</li> </ul>
A. General Rehabilitation and /or Construction Activities	Air Quality	<ul style="list-style-type: none"> <li>(a) Keep demolition debris in a controlled area and spray with water to reduce debris dust.</li> <li>(b) Suppress during pneumatic drilling/wall destruction by ongoing water spraying and/or installing dust screen enclosures at the site.</li> <li>(c) Keep the surrounding environment (sidewalks, roads) free of debris to minimize dust.</li> <li>(d) There will be no open burning of construction / waste material at the site.</li> <li>(e) There will be no excessive idling of construction vehicles at sites.</li> <li>(f) Truck loads should be confinement and protected with lining.</li> </ul>
	Noise	<ul style="list-style-type: none"> <li>(a) Limit construction noise to daytime working hours.</li> <li>(b) During operations, the engine covers of generators, close air compressors, and other powered mechanical equipment, and place equipment as far away from residential areas as possible</li> <li>(c) The maximum allowed speed should be restricted.</li> </ul>
	Water Quality	<ul style="list-style-type: none"> <li>(a) Establish appropriate erosion and sediment control measures such as hay bales and/or silt fences to prevent sediment from moving off-site and causing excessive turbidity in nearby streams and rivers.</li> <li>(b) Wash construction vehicles and machinery only in designated areas where runoff will not pollute natural surface water bodies.</li> <li>(c) Lubricants, fuel and solvents should be stored and used for servicing machinery exclusively in the designated sites, with adequate lining of the ground and confinement of possible operation and emergency spills. Spill containment materials (sorbents, sand, sawing, chips etc.) should be</li> </ul>

		available on construction site.
	Waste management	<ul style="list-style-type: none"> <li>(a) Minimize the amount of generated waste to the extent possible.</li> <li>(b) Separate various types of generated waste and re-use / recycle relevant types of waste to the possible extent.</li> <li>(c) Allocate sites for temporary on-site storage of various types of waste. Do not allow the accumulation of excessive amounts of waste on-site.</li> <li>(d) Obtain formal arrangements with municipal authorities to dispose of household waste and final placement of excess material (inert construction waste).</li> <li>(e) Make timely arrangements for the disposal or hand-over of hazardous waste to licensed companies.</li> </ul>
	Material supply	<ul style="list-style-type: none"> <li>(a) Use existing plants, quarries, or borrow pits with appropriate official approval or valid operating license.</li> <li>(b) Obtain licenses for any new quarries and/or borrowing areas if their operation is required.</li> <li>(c) Reinstate used sections of quarries and/or borrowing areas as extraction proceeds on or properly closed quarries if extraction completed and license expired.</li> <li>(d) Haul materials in off-peak traffic hours.</li> <li>(e) Place speed regulating, diverting, and warning signs for traffic as appropriate.</li> </ul>
B. Individual wastewater treatment system	Water Quality	<ul style="list-style-type: none"> <li>(a) Ensure that the approach of handling sanitary wastes and wastewater and the design of the treatment system is approved by relevant authorities.</li> <li>(b) Ensure that before discharging into receiving waters, effluents from individual wastewater systems are treated in order to meet the minimal quality criteria set out by national guidelines on effluent quality and wastewater treatment</li> <li>(c) Undertake monitoring of newly established wastewater treatment systems and report to Employer on the monitoring outcome</li> <li>(d) Wash construction vehicles and machinery only in designated areas where runoff will not pollute natural surface water bodies.</li> </ul>
J. Community and labor health and safety	Earthworks	<ul style="list-style-type: none"> <li>(a) Topsoil should be stripped before starting of earthworks.</li> <li>(b) Proper topsoil storage practice should be applied to ensure to maintain physical-chemical and biological activity of the soil; Temporary protective silt fencing should be erected to avoid erosion (wash down).</li> <li>(c) Stored topsoil should be used for reinstatement and landscaping.</li> <li>(d) Topsoil from the sites, which will not be reinstated to the initial conditions will be distributed carefully on the surrounding area.</li> </ul>

		<p>(e) Topsoil will be reinstated separately from subsoil, with care taken to avoid mixing of the materials. The topsoil reinstatement will be sufficient to restore the fertile depth to the initial conditions as judged by the topsoil strip during visual observation and comparison of the reinstated site and adjacent land. When replacing the topsoil Contractor will program the works such that the areas furthest away from the stockpiles are reinstated first with reinstatement getting progressively closer to the stockpiles, thus reducing the number of vehicle movements over the reinstated topsoil. The reinstated topsoil will then be harrowed, where practical, to protect the stability and promote vegetative growth.</p> <p>(f) In case chance find is encountered in the course of earth works, the contractor must immediately stop any physical activity on site and informs the MDF. The MDF promptly notifies the Ministry of Culture and Monument Protection, which takes over responsibility for the following course of action. Works may resume only upon receipt of written permission from the Ministry of Culture and Monument Protection.</p>
	Public relationship management	<p>(a) Assign a local liaison person within the Contractor’s team to communicate with and receive requests/ complaints from the local population.</p> <p>(b) Consult local communities to identify and proactively manage potential conflicts between an external workforce and local people.</p> <p>(c) Raise local community awareness about sexually transmitted disease risks associated with an external workforce and include local communities in awareness activities.</p> <p>(d) Inform the population about construction and work schedules, interruption of services, traffic detour routes and provisional bus routes, blasting, and demolition, as appropriate.</p> <p>(e) Limit construction activities at night. When necessary, ensure that night work is carefully scheduled, and the community is adequately informed about taking essential measures.</p> <p>(f) At least five days in advance of any service interruption (including water, electricity, telephone, bus routes), advise the community through postings at the worksite, at bus stops, and in affected homes/businesses.</p> <p>(g) Address concerns raised through Grievance Redress Mechanism established by the Employer within the designated timeline within the scope of Contractor’s liability.</p> <p>(h) To the extent possible, do not locate work camps close to local communities.</p> <p>(i) Undertake siting and operation of worker camps in consultation with neighboring communities.</p>

**PART D: MONITORING PLAN**

<b>Activity</b>	<b>What (Is the parameter to be monitored?)</b>	<b>Where (Is the parameter to be monitored?)</b>	<b>How (Is the parameter to be monitored?)</b>	<b>When (Define the frequency / or continuous?)</b>	<b>Why (Is the parameter being monitored?)</b>	<b>Who (Is responsible for monitoring?)</b>
<b>CONSTRUCTION PHASE</b>						
Supply with construction materials	Purchase of construction materials from the officially registered suppliers	In the supplier's office or warehouse	Verification of documents	During the conclusion of the supply contracts	To ensure technical reliability and safety of infrastructure	MDF, Construction supervisor
Transportation of construction materials and waste  Movement of construction machinery	Vehicles and machinery are kept in standard technical condition;  Truck loads are confined and protected with lining;  Established hours and routes of transportation are respected	Construction site	Inspection	Unannounced inspections during work hours and beyond	Limit pollution of soil and air from emissions;  Limit nuisance to local communities from noise and vibration;  Minimize traffic disruption.	MDF, Construction supervisor, Traffic Police
Earthworks	Temporary storage of excavated material in the pre-defined and agreed upon locations;  Backfilling of the excavated material and/or its disposal to the formally designated locations;  In case of chance finds immediate suspension of works, notification of the Ministry of Culture and Monument Protection, and resumption of works exclusively upon formal consent of the Ministry.  Topsoil is striped before starting of the earthworks;	Construction site	Inspection	In the course of earth works;	Prevent pollution of the construction site and its surroundings with construction waste;  Prevent damage and loss of physical cultural resources;  Prevent topsoil losses.	MDF, Construction supervisor



	<p>Proper topsoil storage practice is applied; Temporary protective silt fencing is erected;</p> <p>Striped topsoil is used for reinstatement and landscaping.</p>					
Sourcing of the natural construction material	<p>Purchase of material from the existing suppliers if feasible;</p> <p>Obtaining of extraction license by the works contract and strict compliance with the license conditions;</p> <p>Terracing of the borrow area, backfilling to the exploited areas of the borrow site, and landscape harmonization;</p> <p>Excavation of river gravel and sand from outside of the water stream, arrangement of protective barriers of gravel between excavation area and the water stream, and no entry of machinery into the water stream.</p>	Borrowing areas	<p>Inspection of documents</p> <p>Inspection of works</p>	In the course of material extraction	<p>Limiting erosion of slopes and degradation of ecosystems and landscapes;</p> <p>Limiting erosion of riverbanks, water pollution with suspended particles, and disruption of aquatic life.</p>	MDF, Construction supervisor
Generation of construction waste	<p>The temporary storage of construction waste in specially allocated areas;</p> <p>Timely disposal of waste to the formally designated locations</p>	<p>Construction site;</p> <p>Waste disposal site</p>	Inspection	Periodically during construction and upon complaints	Prevent pollution of the construction site and nearby area with solid waste	MDF, Construction supervisor
Traffic disruption and limitation of pedestrian access	<p>Installation of traffic limitation/diversion signage;</p> <p>Storage of construction materials and temporary placement of construction waste in a way preventing congestion of access roads and project area</p>	At and around the construction site	Inspection	In the course of construction works	<p>Prevent traffic accidents;</p> <p>Limit nuisance to residents</p>	MDF, Construction supervisor
Workers' health and	Provision of uniforms and safety gear to workers;	Construction site	Inspection	Unannounced inspections in the	The limited occurrence of on-the-job accidents and	MDF,

safety	<p>Provision of potable water and lavatories for men and women at worksite;</p> <p>Informing of workers and personnel on the personal safety rules and instructions for operating machinery/equipment, and strict compliance with these rules/instructions;</p> <p>Adoption and adherence to plan for preventing spread of COVID-19 infection and action in response to the possible outbreak.</p>			course of work	emergencies	Construction supervisor
Works within settlement	<p>Informing affecting population on the upcoming works and any temporary disruptions of municipal service provision that may occur during works;</p> <p>Observance of the established working hours during daytime, minimizing noise and dust emissions, limiting speed of moving construction vehicles and machinery.</p>	Construction site	Inspection	Recurrent	Ensure the safety of residents and minimize nuisance	MDF, Construction supervisor
OPERATION PHASE						
Generation of waste from maintenance of rehabilitated school	Proper management of solid waste	School territory	Inspection	Throughout operation of the school	Prevent pollution with solid waste	MES through the school administration
Operation of sewage biological treatment unit	Providing regular maintenance and timely repair, once required, to the biological treatment unit provided for the school building	School territory	Inspection	During operation of facility	Prevent pollution of surface and ground water with untreated sewage	MES

Attachment 1: Ortho Photo



## Attachment 2: General Plan

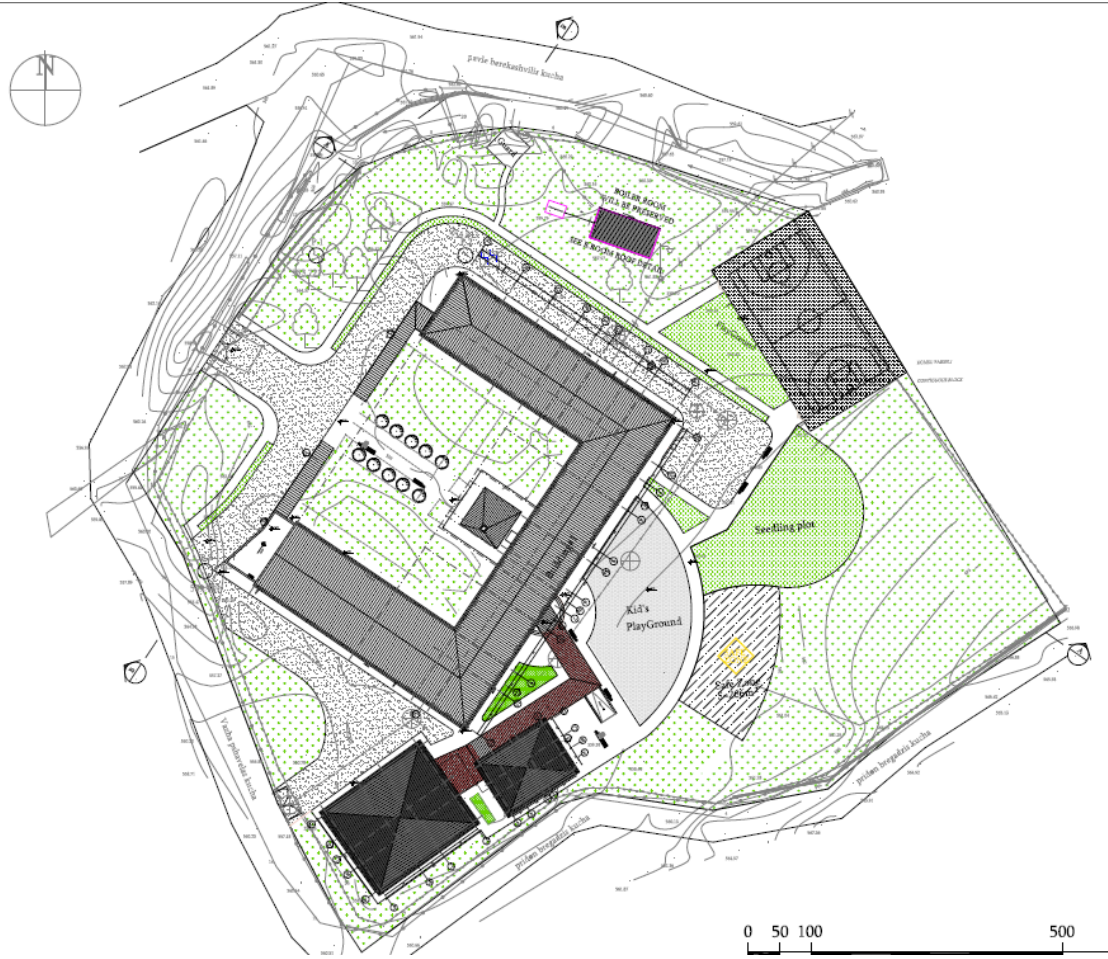

### Attachment 3: Cadastral Plan

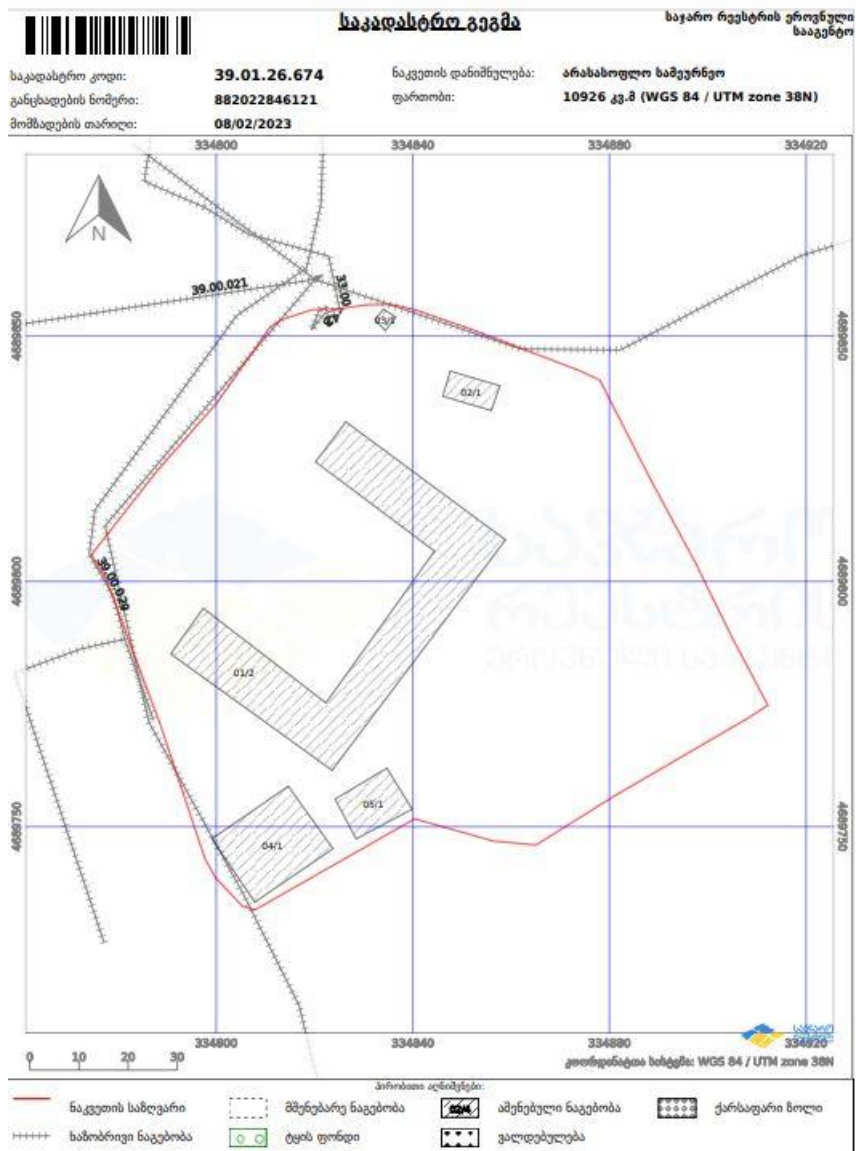

**Attachment 4: Site photo**



**Attachment 5: Design drawings (3D visualization etc.)**



- რკინბეტონის სვეტი R.C. COLUMN
- ქვის პლანტუზი HAMMARED PIETRA GRAY MARBLE SKIRTING
- ფანქარი SKY LIGHT
- ფერადი დემენტის ბათქაში COLORED CEMENT PLASTER #E5982E

<p>Public School #1 - 1K.RU.1  <b>Stage 3</b> : Detailed Design                  Anul Industrial Park                  321 PADOULS</p>	<p>ტერიტორია #1 საჯარო სკოლა                  პედასი 3 მუდარული ფერადი                  ტერიტორიული ნაშრომი                  3D ფანსადები</p>	<p>Detailed Design Preparation for Reconstruction/Rehabilitation for Public Schools Located in Imereti                  შპს-სთვის სამშენებლო პროექტის მომზადება იმერეთის რეგიონის საჯარო სკოლების რეკონსტრუქციისთვის</p> <p><b>Client:</b> შპს "საჯარო სკოლები საქართველო"                  მომხმარებელი</p> <p><b>Consultant:</b> პროექტი - სტრუქტურა                  სტრუქტურა</p>	<table border="1" style="width: 100%; border-collapse: collapse;"> <thead> <tr> <th>შრიტი</th> <th>სტადია</th> <th>დამტკიცების თარიღი</th> <th>დამტკიცებულია</th> <th>დამტკიცებულია</th> </tr> </thead> <tbody> <tr> <td>1</td> <td>პროექტი</td> <td></td> <td></td> <td></td> </tr> <tr> <td>2</td> <td>შეკრულება</td> <td></td> <td></td> <td></td> </tr> <tr> <td>3</td> <td>შეკრულება</td> <td></td> <td></td> <td></td> </tr> <tr> <td>4</td> <td>შეკრულება</td> <td></td> <td></td> <td></td> </tr> </tbody> </table>	შრიტი	სტადია	დამტკიცების თარიღი	დამტკიცებულია	დამტკიცებულია	1	პროექტი				2	შეკრულება				3	შეკრულება				4	შეკრულება				<table border="1" style="width: 100%; border-collapse: collapse;"> <thead> <tr> <th>შრიტი</th> <th>დამტკიცებულია</th> <th>დამტკიცებულია</th> </tr> </thead> <tbody> <tr> <td>1</td> <td></td> <td></td> </tr> <tr> <td>2</td> <td></td> <td></td> </tr> <tr> <td>3</td> <td></td> <td></td> </tr> <tr> <td>4</td> <td></td> <td></td> </tr> </tbody> </table>	შრიტი	დამტკიცებულია	დამტკიცებულია	1			2			3			4		
შრიტი	სტადია	დამტკიცების თარიღი	დამტკიცებულია	დამტკიცებულია																																								
1	პროექტი																																											
2	შეკრულება																																											
3	შეკრულება																																											
4	შეკრულება																																											
შრიტი	დამტკიცებულია	დამტკიცებულია																																										
1																																												
2																																												
3																																												
4																																												
<p>შპს "საჯარო სკოლები საქართველო" - შპს "საჯარო სკოლები საქართველო" - შპს "საჯარო სკოლები საქართველო"</p>				<p>შპს "საჯარო სკოლები საქართველო" - შპს "საჯარო სკოლები საქართველო" - შპს "საჯარო სკოლები საქართველო"</p>																																								
<p>შპს "საჯარო სკოლები საქართველო" - შპს "საჯარო სკოლები საქართველო" - შპს "საჯარო სკოლები საქართველო"</p>				<p>შპს "საჯარო სკოლები საქართველო" - შპს "საჯარო სკოლები საქართველო" - შპს "საჯარო სკოლები საქართველო"</p>																																								